

BODHI
TULUM

zoom 
playa
REAL ESTATE BROKER

The term **BODHI** comes from Sanskrit, and means to awaken, to understand.

This project seeks to accompany this awakening by reconnecting us with our primary environment: **Nature**.



41 residences of 1 to 3 bedrooms surrounded by vegetation. The towers are designed and distributed to work in synergy with the wind, water and light provided by the jungle. The construction respects the materials and finishes of the area, creating a blend between the vernacular and the contemporary. Each unit is designed for privacy, exclusivity and comfort with completely green views.



41 units on
10.000m² of land



Sustainable
development



Exclusivity and
privacy



Bioclimatic design



Embracing Nature's Breath: Experience the tranquility of a **low-density** project rooted in soil respect.

The complex houses 41 units on 10,000 m² of land, preserving almost 70% of the natural green areas.

The entire construction is founded on piles, affecting the permeability of the soil by only 13%. This allows for the absorption of rainwater, the free flow of animals and the growth of tree and plant roots. All this provides better climatic and thermal conditions for the users.

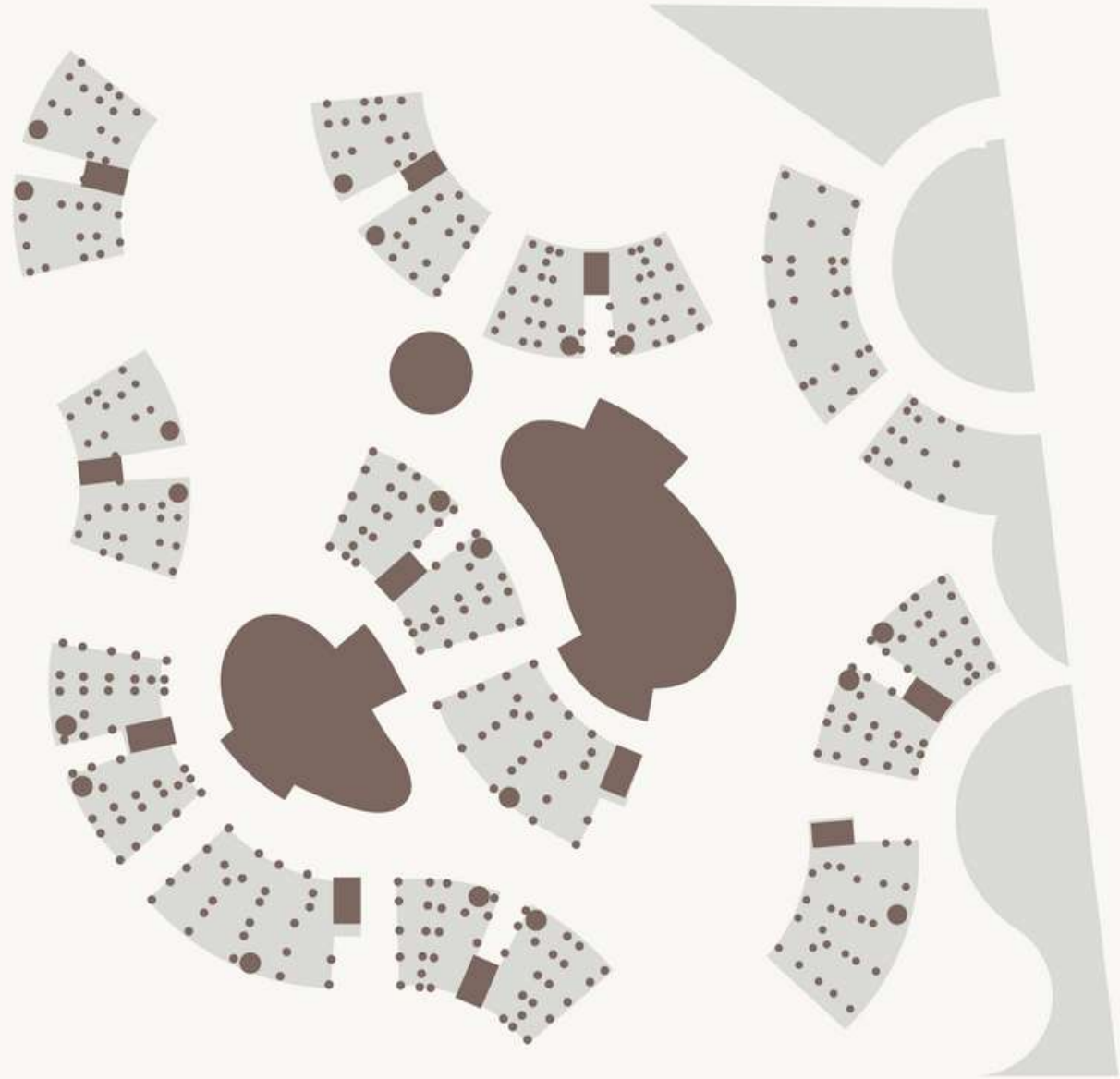

■ Total non-permeable area: 1,353 m²



BODHI
TULUM

March 2023 Construction Progress

Transforming real estate & empowering change: Our commitment to a **sustainable tomorrow**



Bioclimatic design | The project takes into account the local climate and seeks to make the most of natural lighting and ventilation, favoring comfort and reducing energy consumption.



Rainwater harvesting | Each tower has roofs specially designed to capture and collect rainwater, which will be used for the irrigation system in times of drought. In this way, the use of natural resources is optimized and the consumption of drinking water is reduced.



Solar energy | All towers are equipped with solar panels, reducing the consumption of each unit.



Chemical-free pools. | Both pools are equipped with a physical and biological filtering system, avoiding chemical contamination released by chlorination systems. This reduces maintenance costs and helps to preserve the natural balance of the environment and its users.



Double-glazed windows | The units are fitted with dual glazing, which provides greater thermal and acoustic insulation, offering freshness and comfort in the interiors, as well as energy savings.



Water treatment | The complex has wastewater treatment, providing a dual use for the project's water and preventing subsoil contamination of the world's largest underwater cavern system.



Organic waste treatment | The complex will have an organic waste composting system, ideal for turning our waste into food for the green areas.



Rediscover tranquility in our meticulously designed units.

Chukum Walls

Floor-to-ceiling windows with double glazing, ensuring acoustic insulation

Independent walls that guarantee the privacy and tranquility of the users in each unit.

Each unit has its own Jacuzzi with Sukabumi and black lava finishes.



Typologies

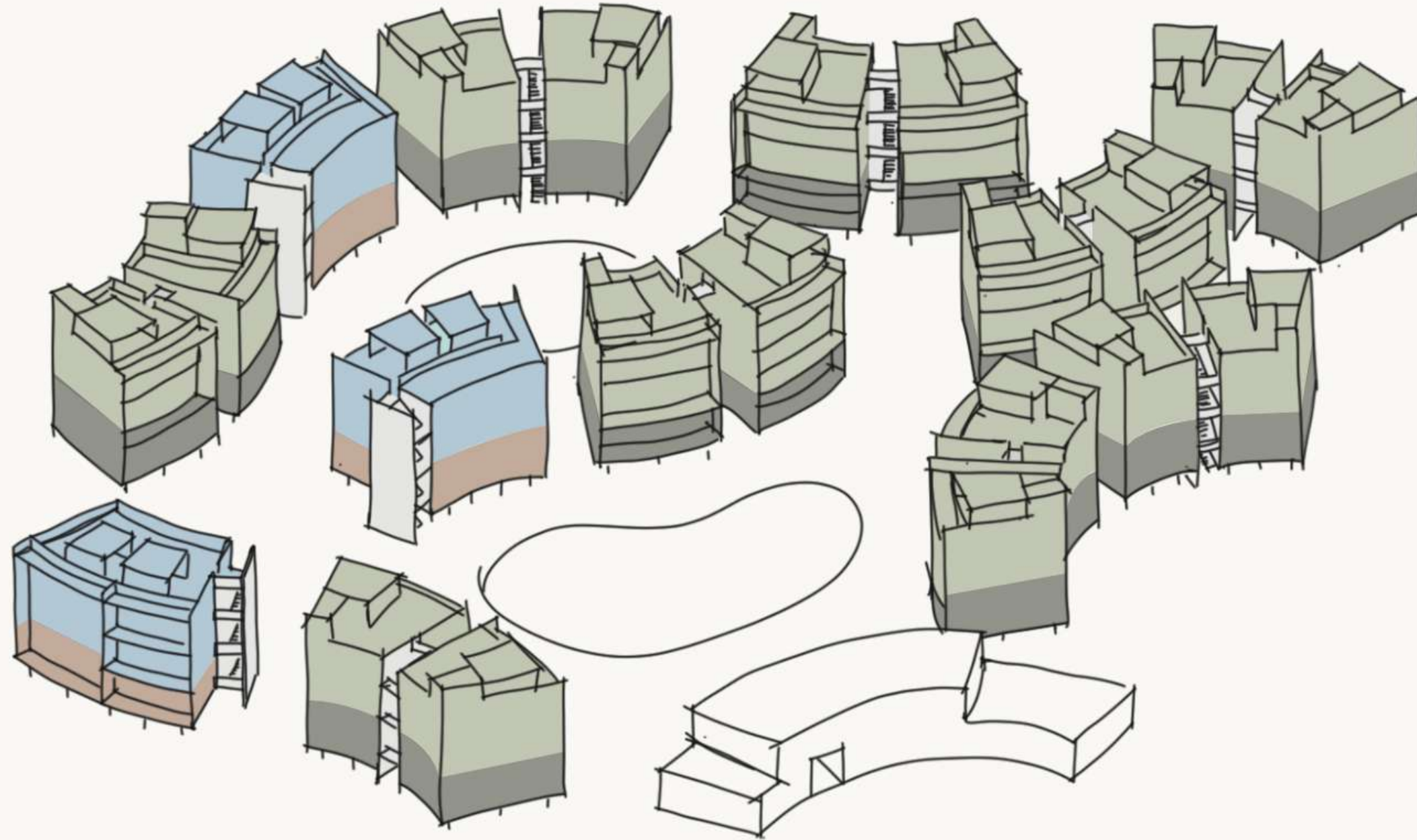

Metta



Mudita



Upeksha



Sattva



Metta



Ground floor

83 m²



1



1



1





BODHI
TULUM

Metta - View from terrace



BODHI
TULUM

Metta - View from kitchen

Mudita

Lock - off room



First floor



Second floor



Terrace

181^{m2}



2



2



1



1





BODHI
TULUM



Mudita - View from terrace



BODHI
TULUM

Mudita - Bedroom

Upeksa



Ground floor

167 m²



3



2



1



1





BODHI
TULUM

Upeksa - View from kitchen

Sattva 1



second / third floor



Terrace

174 m²



3



2



2



1



Sattva 2



Second / third floor



Terrace

186^{m2}



3



2



2



1





BODHI
TULUM

Sattva - Bedroom



BODHI
TULUM

Sattva - Terrace

Amenities

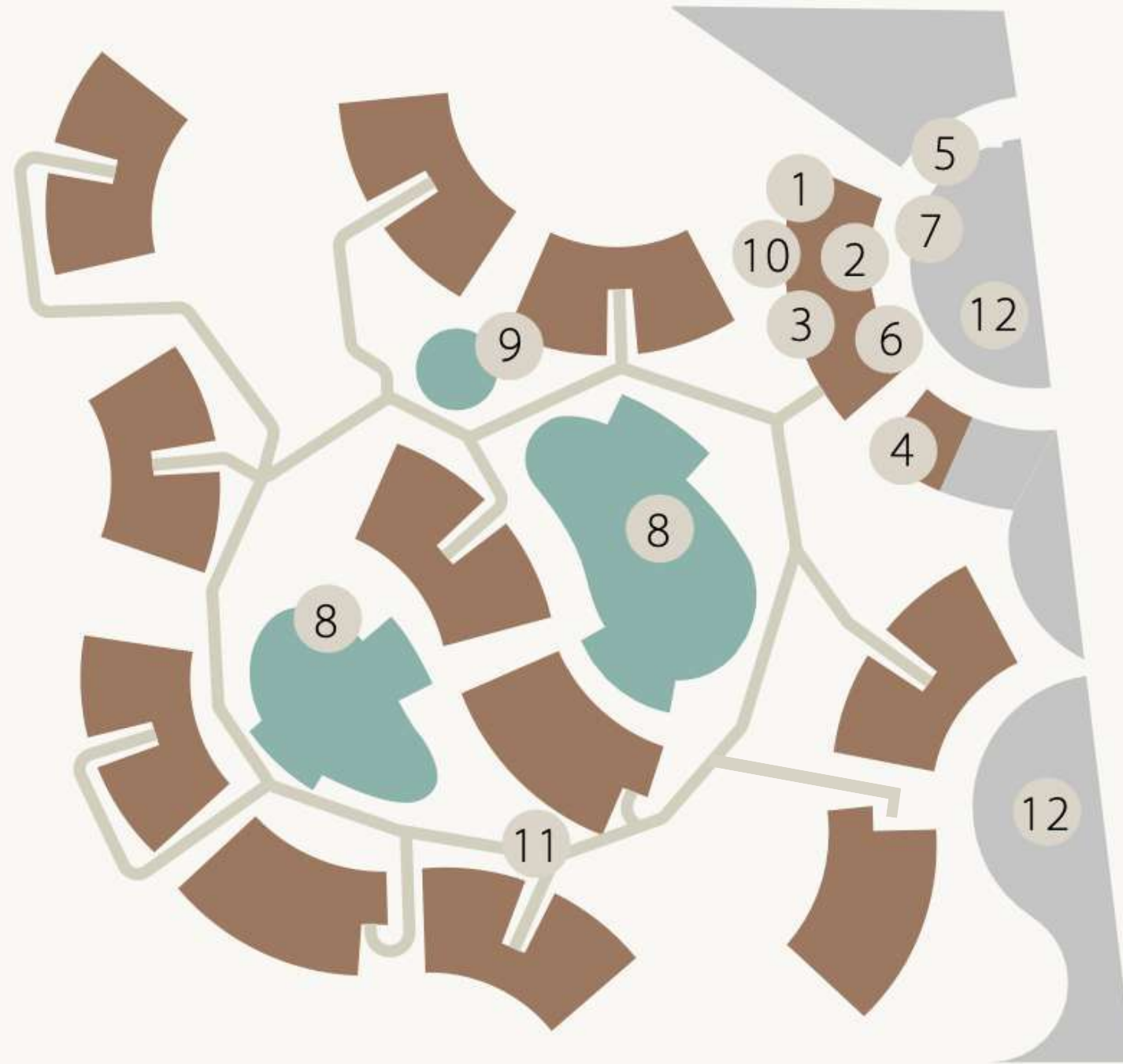

- 1 Gym
- 2 Restaurant
- 3 Terrace
- 4 Reception
- 5 Motor-Lobby
- 6 Concierge
- 7 Shuttle to the beach
- 8 2 ecological swimming pools
- 9 Swimming pool bathrooms
- 10 Multi-purpose room
- 11 High bridges connecting the entire complex
- 12 Parking



Invest without worries. At Bodhi, we are also committed to taking care of your time. Our management focused on holiday rentals takes care of everything necessary for you to generate profitable income while keeping your property in the best conditions.

A promising investment for those who want a holiday property that generates an attractive income.



BODHI TULUM



Location

One of the most visited destinations in the world. **Tulum** is an excellent opportunity for real estate investment in Mexico for its infrastructure, tourism potential and economic growth. The lifestyle surrounded by nature, paradisiacal beaches and outdoor activities position Tulum in the eco-chic trend worldwide.

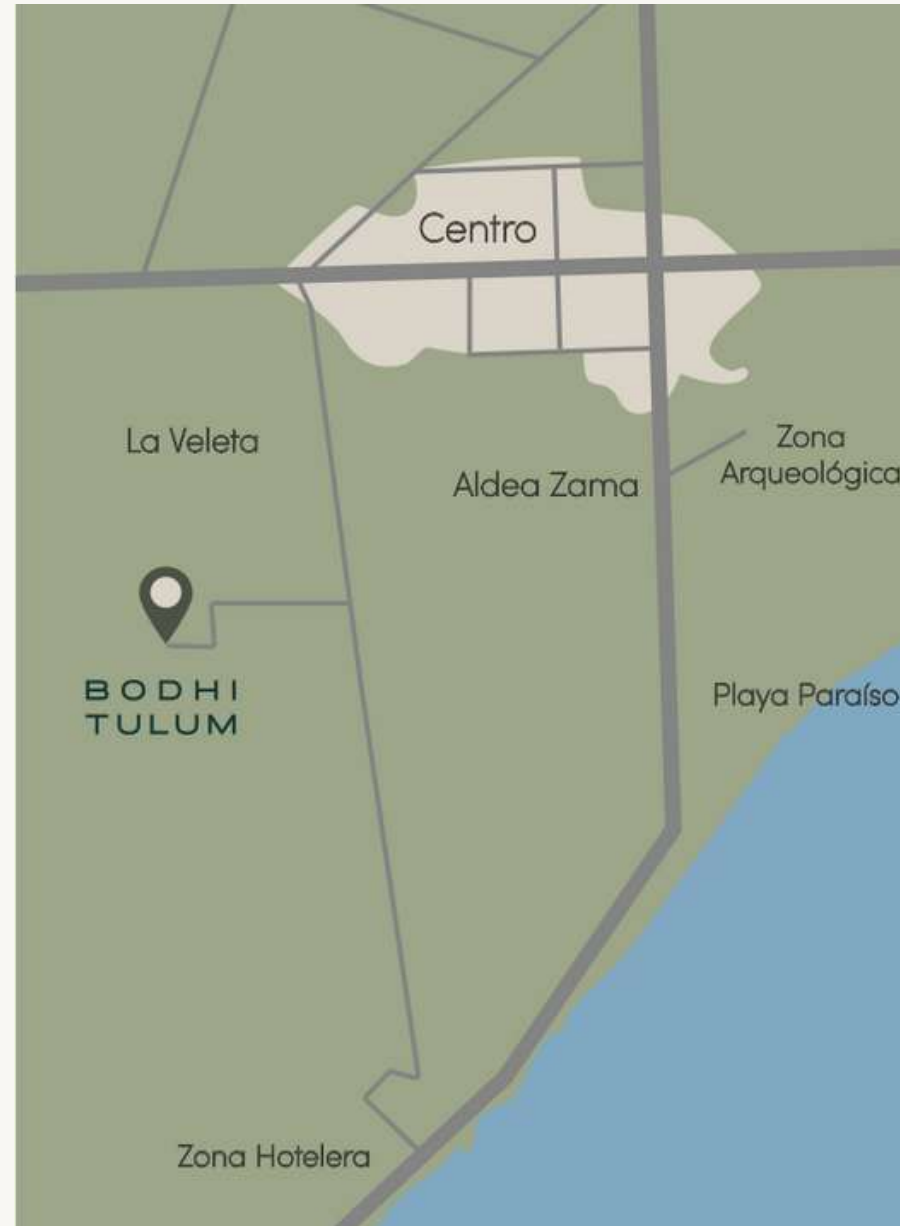

Beach | 4 minutes

Downtown | 4 minutes

Holistika | 5 minutes

Gypsea Market | 5 minutes

Hospital | 10 minutes

Supermarket | 10 minutes

Cenotes | 12 minutes

Archaeological Site | 15 minutos

Siaan Kaan reserve | 20 minutes

Playa del Carmen | 45 minutes

zoom playa

REAL ESTATE BROKER

Contact us:

zoomplaya.com



info@zoomplaya.com



Zoom Playa Real Estate



+52 984 104 0140



[zoomplaya](https://www.instagram.com/zoomplaya)



[zoomplayarealestate](https://www.tiktok.com/@zoomplayarealestate)



[zoomplaya](https://www.facebook.com/zoomplaya)